



Redmond
SENIOR & COMMUNITY CENTER
Building our future **TOGETHER**

Community Meeting #1

Redmond Senior & Community Center

February 24, 2021



Participating in Today's Meeting



Redmond
SENIOR & COMMUNITY CENTER
Building our future **TOGETHER**

- Stay **on mute** unless you are speaking
- Drop thoughts or comments into the **chat box**
- There will be a **5-min break** halfway through
- We will have a **Q&A session** and time for discussion in small **breakout rooms**

Agenda for Today's Meeting



Redmond
SENIOR & COMMUNITY CENTER
Building our future TOGETHER

Welcome and Introductions

Where We've Been

Where We're Going

The Project Vision

Program Visuals: Senior Center and Community Spaces

Program Visuals: Recreation Spaces

How We'll Get There: Your Input

Who We Are



City Team

Carrie Hite
Loreen Hamilton
Eric Dawson



Stakeholder Group Representatives

LouAnn Ballew
Angie Hinojos



Design & Outreach Team

Jim Kalvelage
Chris Roberts
Alison Peters
Aileen Dinh
Sarah Omlor



Where We've Been

Community Center Priorities from 2017-2020



Redmond
SENIOR & COMMUNITY CENTER
Building our future TOGETHER

- Larger, enhanced spaces that are welcoming and accessible to serve our displaced senior population
- Increase accessibility and services for all ages through flexible spaces
- Environmentally sustainable building practices
- Build community across cultures
- Provide opportunity for recreation, fitness, cultural gatherings, and events

2017 Community Center Priorities

URGENCY FOR ACTION

Within **five years**,
balance competing
priorities

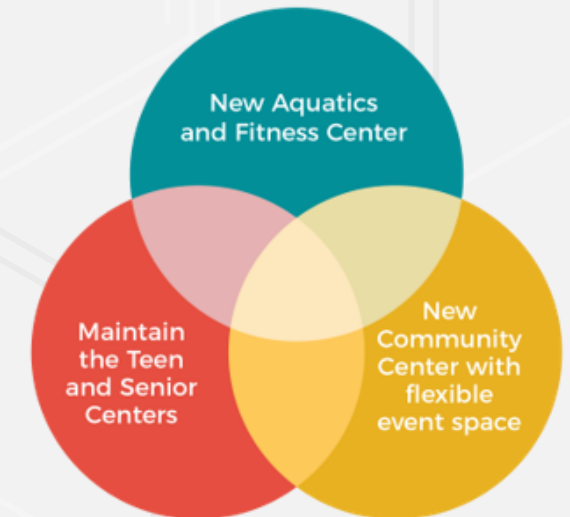



**Redmond
SENIOR & COMMUNITY CENTER**
Building our future TOGETHER

Redmond Senior Center Building Demolished



Decline in Community Spaces

Redmond's Community Centers	2000-2017	2018-2019	2020	2021
	Old Redmond Schoolhouse, Redmond Senior Center, and OFH Teen Center <small>*The Old Redmond Schoolhouse closed in December 2017.</small>	Redmond Community Center, Redmond Senior Center, and OFH Teen Center <small>*The Senior Center closed in September 2019</small>	Redmond Community Center and OFH Teen Center <small>*The Old Redmond Schoolhouse reopens in a limited capacity in December 2020</small>	Redmond Community Center, OFH Teen Center and Old Redmond Schoolhouse
Total Square Feet	72,300 sf	50,600 sf	28,600 sf	38,300 sf
Small Meeting/Program Space (1-15 people)	9	5	1	1
Medium Meeting/Program Space (15-34 people)	9	8	4	4
Large Meeting/Program Space (35-70 people)	6	4	2	2
Event Space	ORSH Auditorium (250 people) RSC Social Hall (200 people) OFH Showroom (100 people)	RSC Social Hall (200 people) OFH Showroom (100 people)	OFH Showroom (100 people) No performance stage	OFH Showroom (100 people) No performance stage
Commercial Kitchen	2	2		
Specialty Spaces	Clay Studio with kiln Recording Studio Library	Lecture Hall Drop-in Fitness Studio Recording Studio Library	Lecture Hall Drop-in Fitness Studio Recording Studio	Lecture Hall Drop-in Fitness Studio Recording Studio Clay Studio with kiln
Dance Studio	1			1
Gymnasium	1			1

New Senior Center Urgently Needed



**Redmond
SENIOR & COMMUNITY CENTER**
Building our future **TOGETHER**

Former Redmond Senior Center (up to 2019)

Lobby, Gathering Area & Coffee Bar
Senior Lounge
Commercial Kitchen and Dining Room
Billiards area
Library
Social Hall, with performance stage and dressing room
Dance Studio (max cap 45)
Crafters Gallery
Arts & Crafts Room (max cap 35)
Wellness Room (max cap 4)
Conference Room (max cap 8)
Two flexible classrooms, including Card & Game Room (max cap 35 to 40)
Greenhouse

Total Area 22,000 gsf

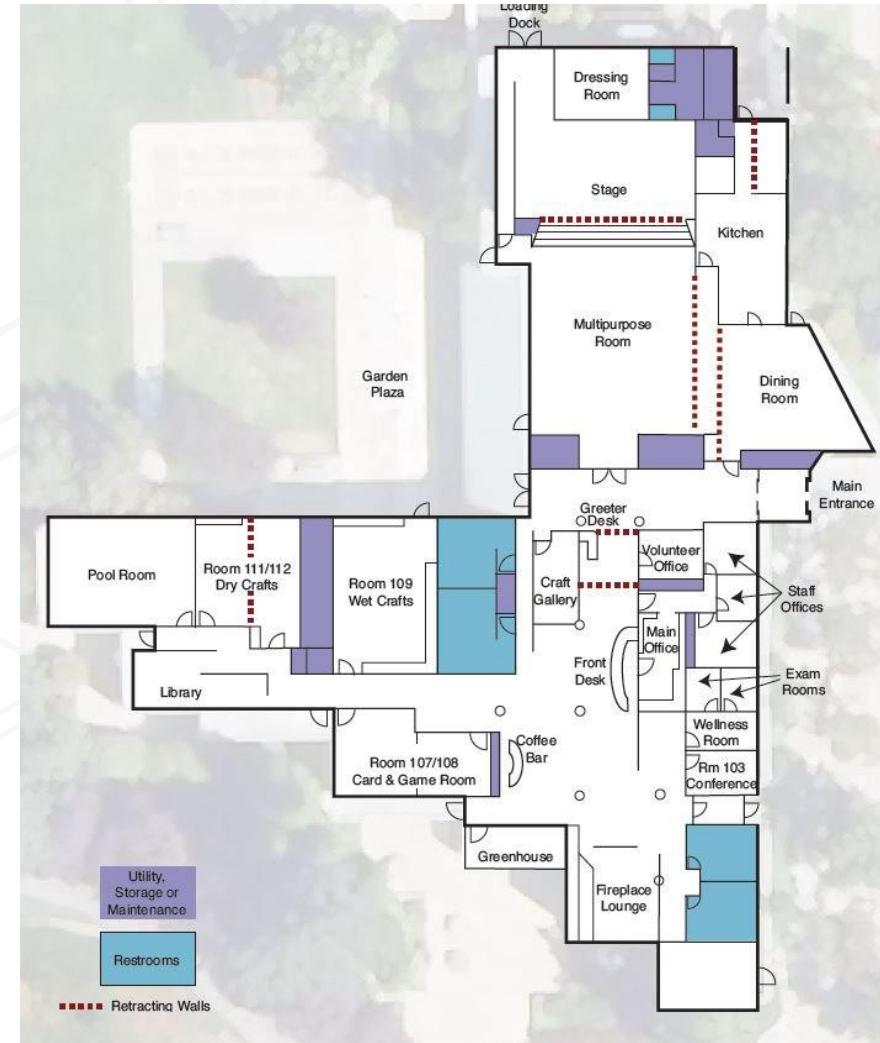







Project background



**Redmond
SENIOR & COMMUNITY CENTER**
Building our future **TOGETHER**

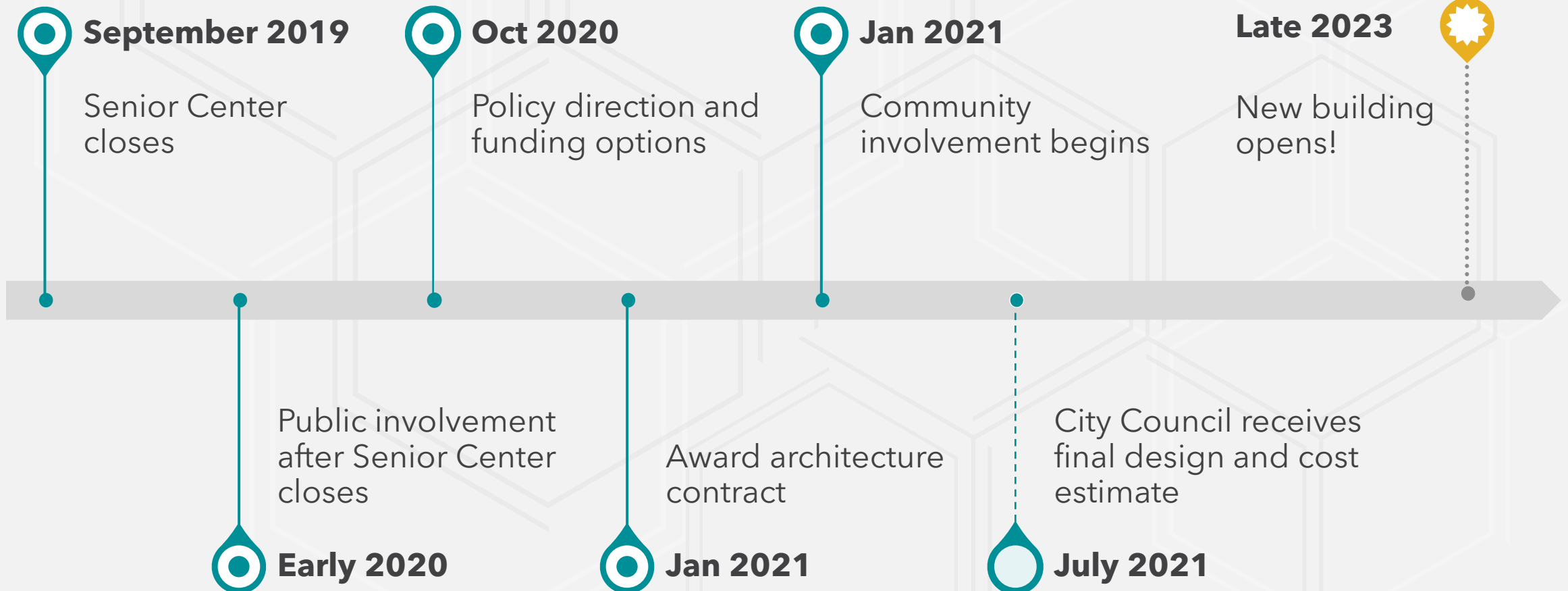

Partnership Update



Redmond
SENIOR & COMMUNITY CENTER
Building our future TOGETHER

- Submittals
- Evaluation Process
 - Timing
 - Financing
 - Alignment

From the Request: *"A prospective partner will propose a complementary use to the Senior and Community Center and would work with the City Project Manager to finalize the project concept, partnership terms, and timing. The City seeks a creative partner that will enhance this facility and provide demonstrable community benefits."*

Other considerations:

- + City's sustainability ordinance
- + Vertical expansion or an expanded footprint?





Where We're Going

Preliminary Project Schedule



Redmond
SENIOR & COMMUNITY CENTER
Building our future TOGETHER

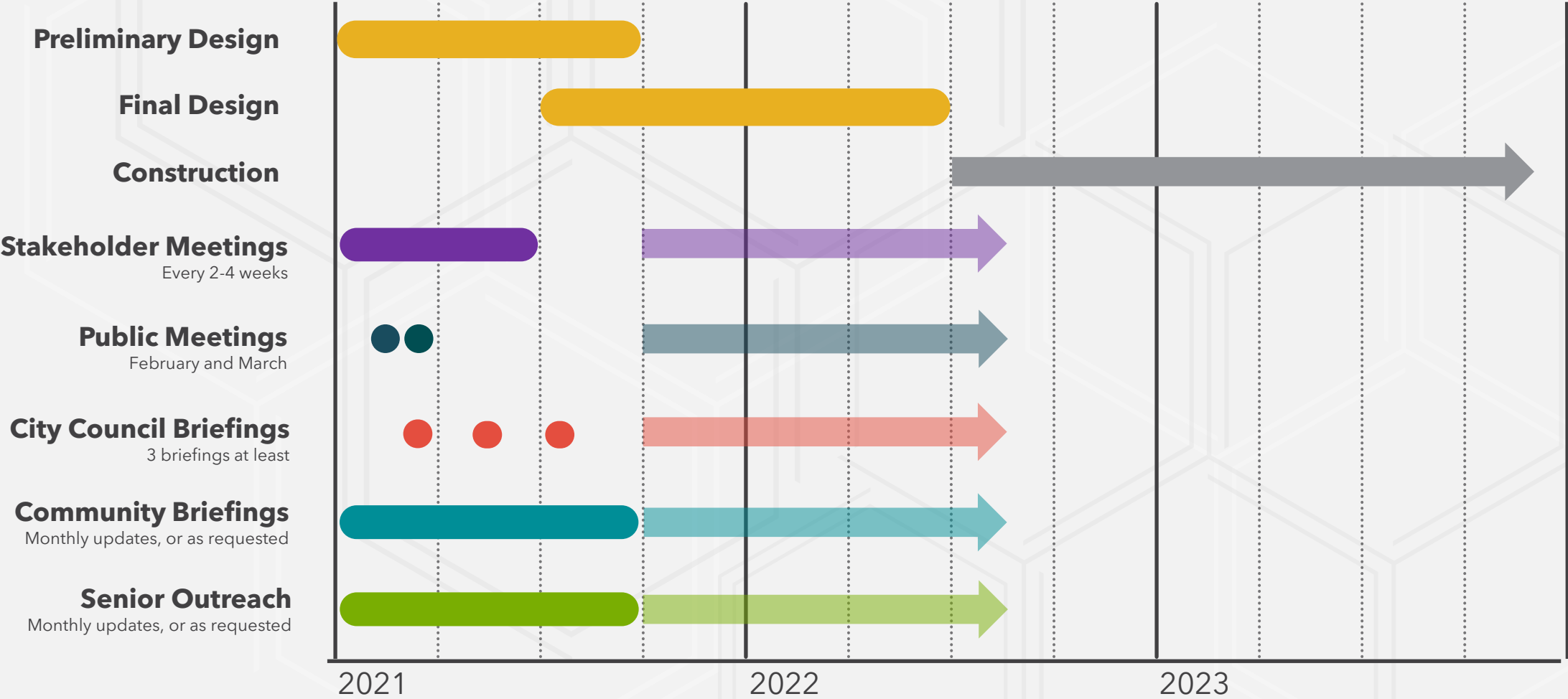

Proposed Site in Context



Redmond
SENIOR & COMMUNITY CENTER
Building our future **TOGETHER**

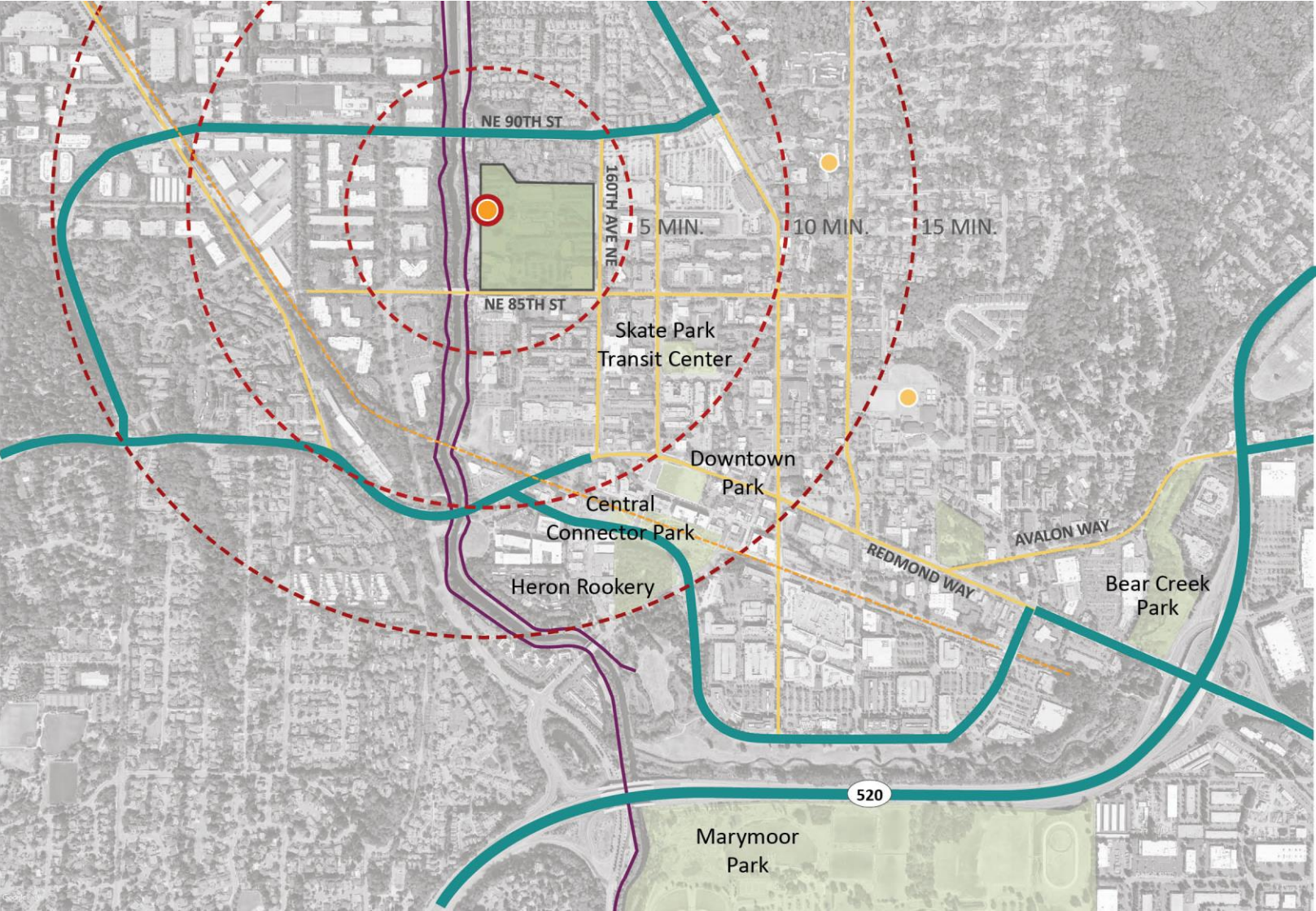

- MAJOR ARTERIAL
- MINOR ARTERIAL
- SAMMAMISH RIVER TRAIL
- CENTRAL CONNECTOR TRAIL
- SCHOOLS
- PARKS
- WALKING RADII
- SENIOR COMM. CENTER

Site Opportunities



**Redmond
SENIOR & COMMUNITY CENTER**
Building our future **TOGETHER**

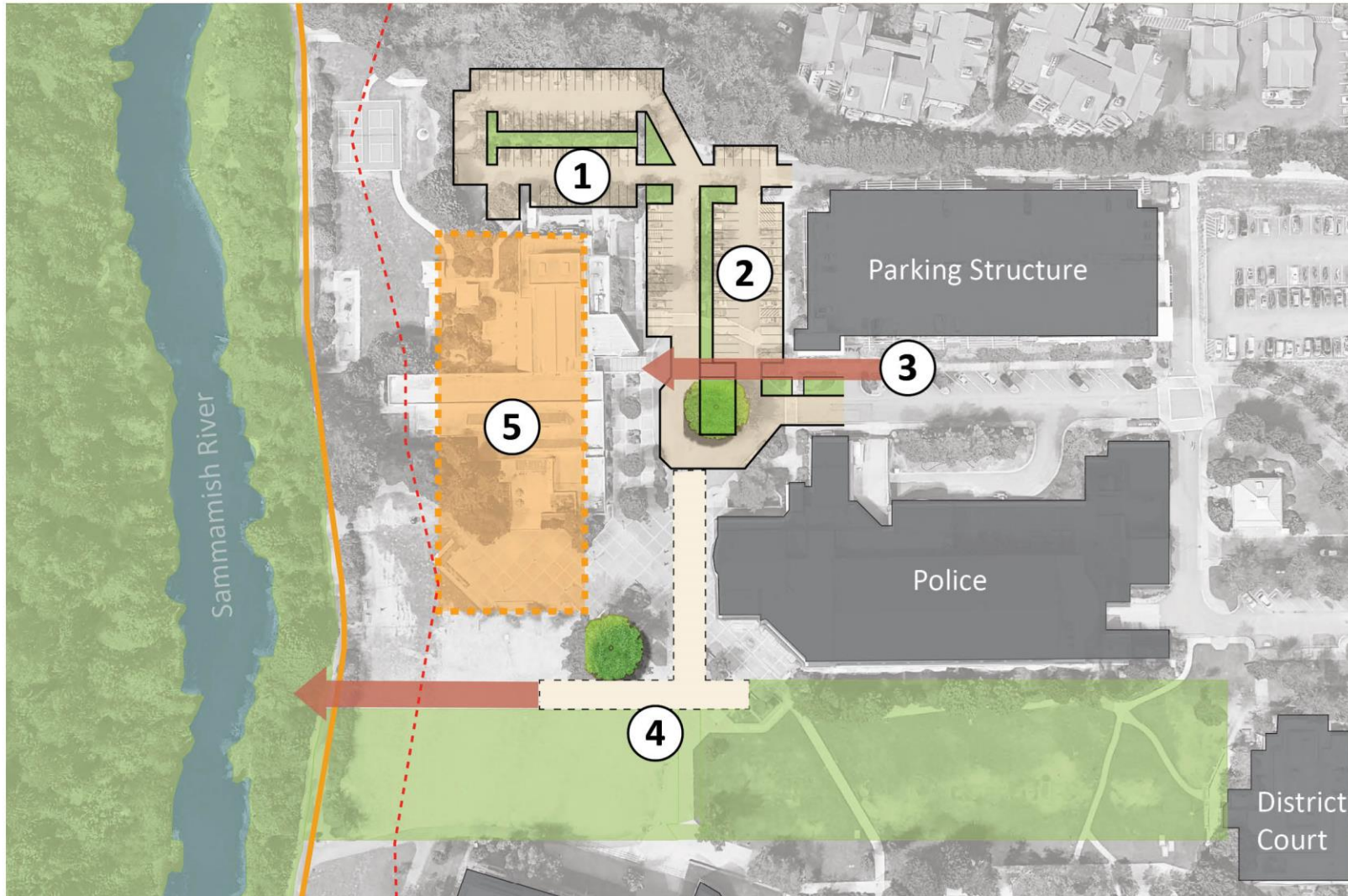

- ① SENIOR PARKING LOT
- ② INCREASE PARKING
- ③ STRENGTHEN PATHWAY
- ④ RELOCATED FIRELANE
- ⑤ DEVELOPABLE AREA
- SAMMAMISH RIVER TRAIL
- - - CRITICAL AREAS BUFFER - 150'



Vision for a New Senior & Community Center

This Project is a Commitment to:



Redmond
SENIOR & COMMUNITY CENTER
Building our future TOGETHER

- ✓ A welcoming, safe, accessible place for seniors
- ✓ Adding more recreation options for seniors and the community
- ✓ Inclusion and celebrating Redmond's diverse cultures
- ✓ The city's new Sustainability ordinance
- ✓ Consider high-value community partners
- ✓ Operational efficiencies and revenue generation

Q & A

1. Raise hand if you'd like to ask your question aloud and come on video OR
2. Type your question into the chat if you'd like Alison to ask your question



Let's take a 5-minute comfort break



Spaces and Programs

Types of Spaces



Redmond
SENIOR & COMMUNITY CENTER
Building our future TOGETHER

Senior
Dedicated
Spaces

Community
Shared
Spaces

Recreation
Spaces

Outdoor
Spaces

Space Program & Operational Costs



Redmond
SENIOR & COMMUNITY CENTER
Building our future **TOGETHER**

Potential Space Program

Senior Lounge, Library Room & Card Game Area
Senior Entrance and Welcome Area
Multi-Use Community Room with Performance Stage
Commercial Kitchen
Multi-Use Room
Wellness Exam Rooms
Arts & Crafts Room
Music Room
Active Recreation Space
Games Area
Group Exercise Room
Strength & Weight Training Area
Walk / Jog Track
Kids Zone
Outdoor Spaces

Total Area **40,000-46,000 gsf**

Senior Center & Community Spaces



Redmond
SENIOR & COMMUNITY CENTER
Building our future TOGETHER

This includes:

- Senior entrance and welcome desk
- More senior parking closer to entrance
- Lounge and coffee cart
- Library
- Volunteer room
- More storage
- Kitchen and dining room
- Larger Community Room
- New combination music & green room



Senior Lounge



**Redmond
SENIOR & COMMUNITY CENTER**
Building our future TOGETHER



Library Room



**Redmond
SENIOR & COMMUNITY CENTER**
Building our future TOGETHER



Community Room



Flexible space for:

- ✓ Rentals
- ✓ Senior lunch nutrition program
- ✓ Dance or music classes
- ✓ Community performances



Art, Music and other Flexible Spaces



Recreation Spaces



**Redmond
SENIOR & COMMUNITY CENTER**
Building our future TOGETHER

This includes:

- **18,000 sf** of new recreation space
- Group exercise
- Fitness amenities
- Walk/jog track
- Flexible gym space, subdivided (indoor pickleball, basketball leagues, volleyball)
- Flexible spaces for recreation activities



Group Exercise and Fitness



**Redmond
SENIOR & COMMUNITY CENTER**
Building our future TOGETHER



Strength & Weight Training Area



**Redmond
SENIOR & COMMUNITY CENTER**
Building our future TOGETHER



Kids Zone



Redmond
SENIOR & COMMUNITY CENTER
Building our future TOGETHER





Breakout Room Discussion

Discussion Groups



Redmond
SENIOR & COMMUNITY CENTER
Building our future TOGETHER

We will split you into groups. Each room has a facilitator and some questions:

Questions (these will go in the chat):

- What are your initial impressions?
- What are your top program priorities?
- What's missing?
- Any surprises to you?

Wrap Up



Redmond
SENIOR & COMMUNITY CENTER
Building our future TOGETHER

What were your biggest take-aways in your group?



How We'll Get There

Staying Engaged



**Redmond
SENIOR & COMMUNITY CENTER**
Building our future **TOGETHER**

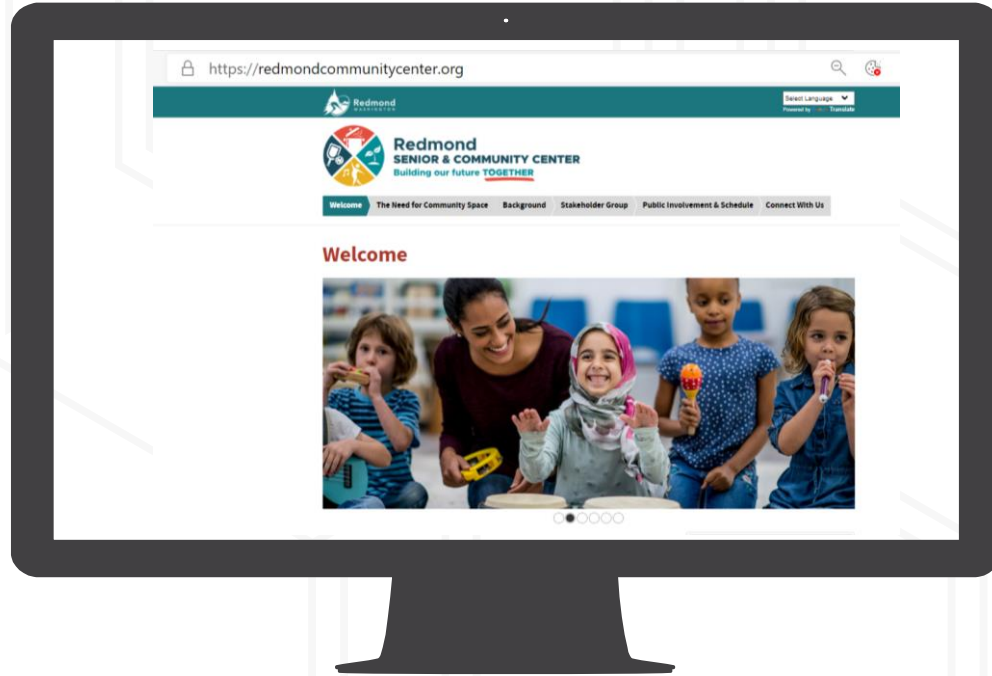

*The project website and the
community questionnaire are live now*

- Senior-only Zoom public meetings, email updates, and Encore Newsletters
- Virtual Public Meetings
- Project inbox at comment@redmondcommunitycenter.org
- Stakeholder Meetings
- Commission and Committee briefings
- City Council briefings
- Social media posts and newsletters
- Electronic comment form
- Outreach to cultural groups, nonprofits, businesses, participants, etc.

Next Public Meeting: March 24

- Show and Discuss Updated Space Program and Cost Recovery
- Show and Discuss Building Concept
- Discuss Site Analysis & Parking Needs



Redmond
SENIOR & COMMUNITY CENTER
Building our future **TOGETHER**

Thank you

Carrie Hite, Parks and Recreation Director
chite@Redmond.gov | 425-556-2326

Loreen Hamilton, Parks and Recreation Deputy Director
lhilton@Redmond.gov | 425-556-2336

Eric Dawson, Project Manager
ecdawson@redmond.gov | 425-556-2867



Helpful Resources



Redmond
SENIOR & COMMUNITY CENTER
Building our future TOGETHER

Project website: www.redmondcommunitycenter.org

Inbox: comment@redmondcommunitycenter.org

Comment card:

<https://forms.office.com/Pages/ResponsePage.aspx?id=DQSIkWdsW0yxEjajBLZtrQAAAAAAAAAAAAAAAAAANAACABhBVUOEI2UVRRSIBCUEFLM0pHMINDTEVLQ0U1Ry4u>

Customer service phone number: 425-556-2300

Next City Council business meeting: April 20